

Assembly instruction

Version 1.0

Machine stand

3440408

To be used on the lathes D280x700, D240x500, D250x550 and D210x400!

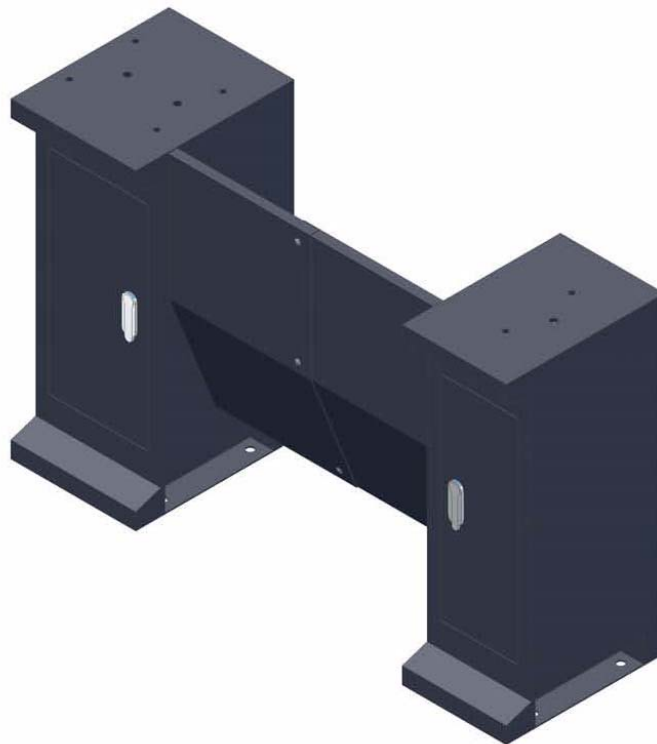

Keep for future reference!

1 Assembly instruction





INFORMATION

Everyone involved in the assembly and commissioning needs to

- be duly qualified,
- strictly follow these assembly instructions.

1.1 Safety

Glossary of symbols

	gives further advice
	calls on you to get in action
	enumerations

This part of the assembly instruction

- does explain the meaning and how to use the warning references contained in this operating manual,
- determines the proper use of the lathe respectively of the machine stand,
- highlights the dangers that might arise for you and others if these instructions are not observed,
- informs you on how to prevent dangers.

In addition to this operating manual, please note

- applicable laws and regulations,
- legal regulations for preventing an accident,
- the prohibition, warning and mandatory signs as well as the warning notes on the lathe.

Always keep this document close to the lathe.



INFORMATION

If you are not able to solve a problem using these assembly instructions, please contact:

Optimum Maschinen Germany GmbH
Dr. Robert-Pfleger-Str. 26

D-96103 Hallstadt



Phone: 09 00 - 19 68 220 (0.49 €/min.)

E-mail: info@optimum-maschinen.de

1.2 Safety warnings (warning notes)

1.2.1 Classification of hazards

We classify the safety warnings into various levels. The table below gives an overview of the classification of symbols (pictograms) and warning alerts for each specific danger and its (possible) consequences.

Pictogram	Warning alert	Definition/Consequences
	DANGER!	Threatening danger that will cause serious injury or death to the people.
	WARNING!	Risk: a danger that might cause serious injury or death to people.
	CAUTION!	Danger or unsafe procedure that might cause injury to people or damage to property.
	ATTENTION!	Situation that could cause damage to the machine and to the product and other types of damages. No risk of injury to people.
	Information	Application advice and other important or useful information and notes. No dangerous or harmful consequences for people or objects.

In case of certain dangers, we replace the pictogram by



1.3 Installation and assembly

1.3.1 Requirements regarding installation site

Arrange the workspace around the lathe according to the local safety regulations.

The workspace for the operation, maintenance and repair must not be hindered.

Check the horizontal orientation of the base using a spirit level. Adjust any unevenness using sheet metals or other appropriate means.

1.3.2 Mounting the machine stand for D280x700

- Mount the front panel to the side parts of the machine stand using the attached fixing material. Slightly turn the hexagon socket screws.
- Screw the front panels using the button head screws and the hexagon nuts.

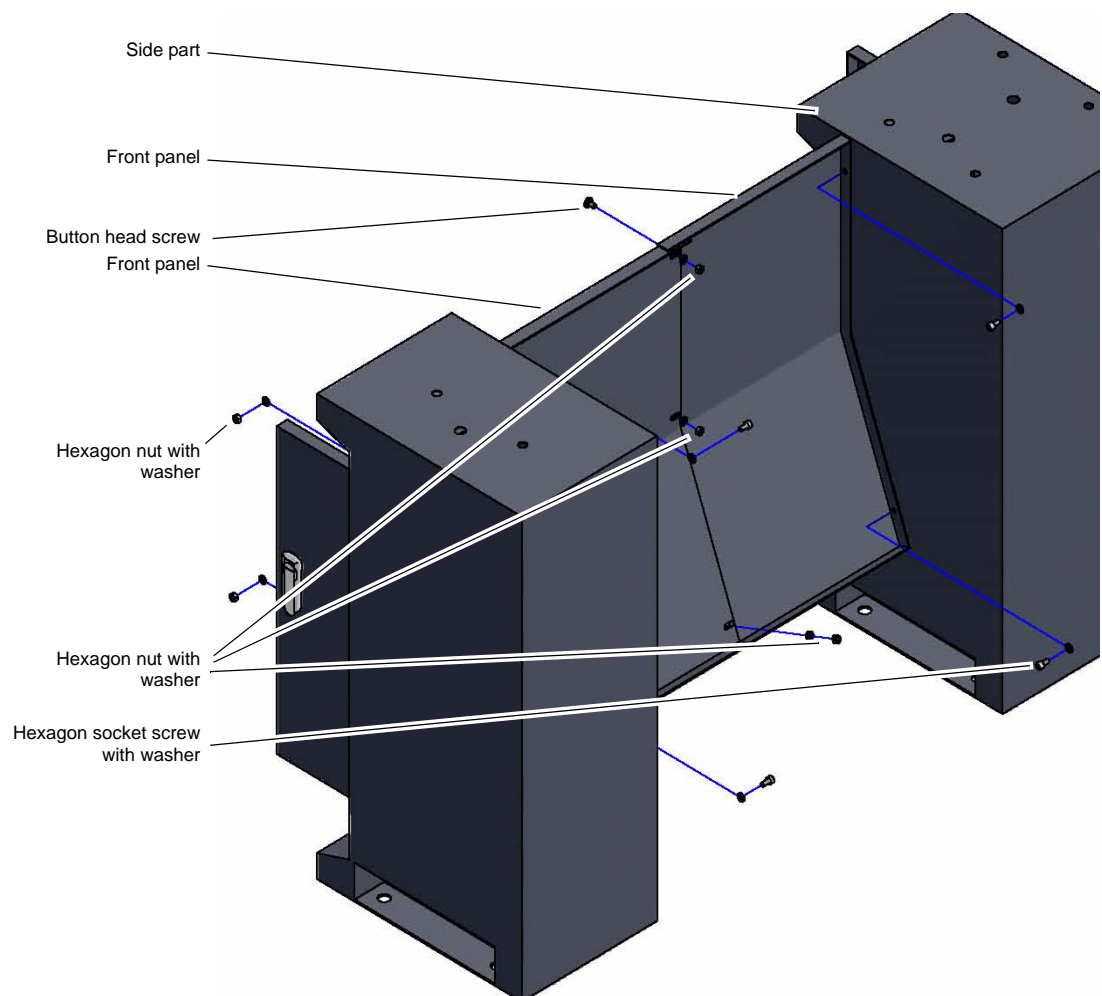

Fig.1-1: Assembly scheme machine stand - rear view

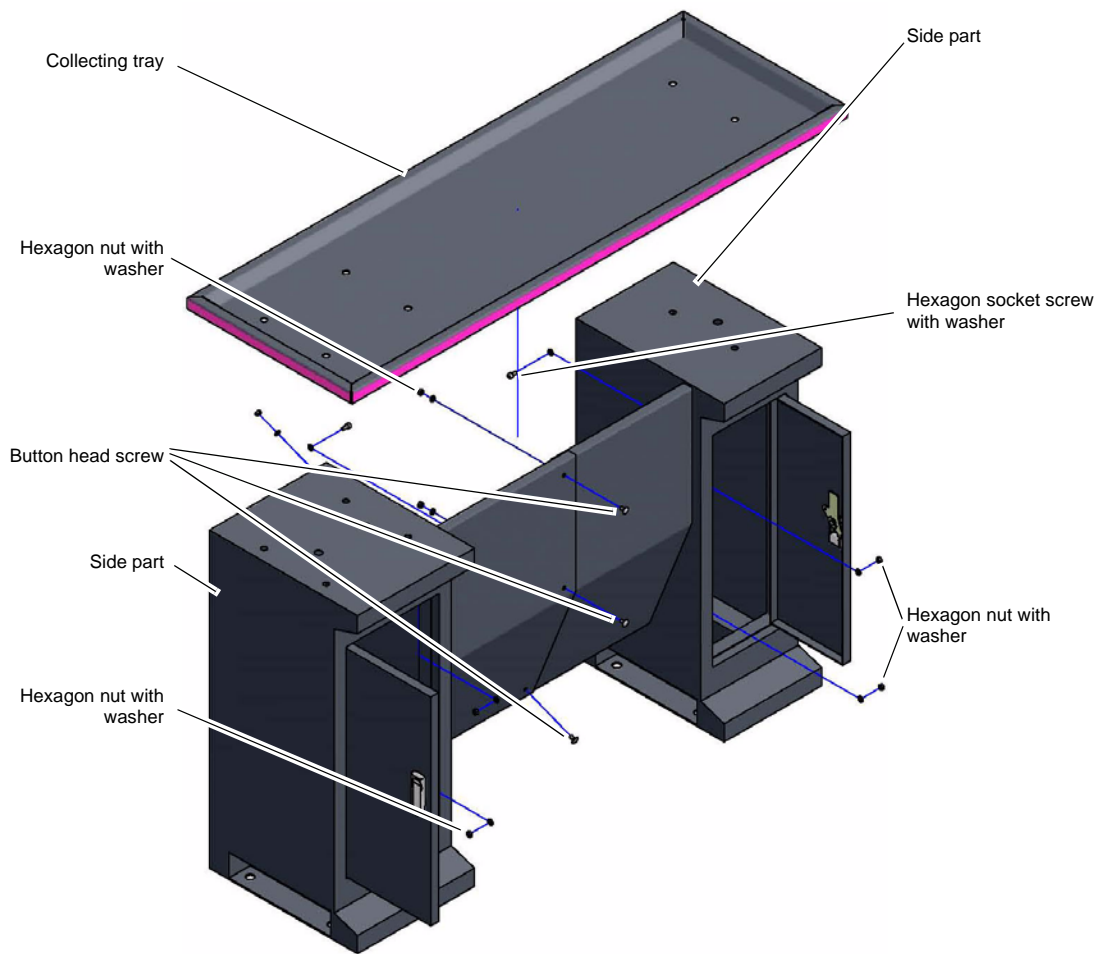

Fig. 1-2: Assembly scheme machine stand - front view

→ Lift the lathe as well as the collecting tray on the machine stand using an appropriate handling device.



ATTENTION!

Make sure that the connecting cable is neither crushed nor damaged when lifting the lathe on the machine stand!

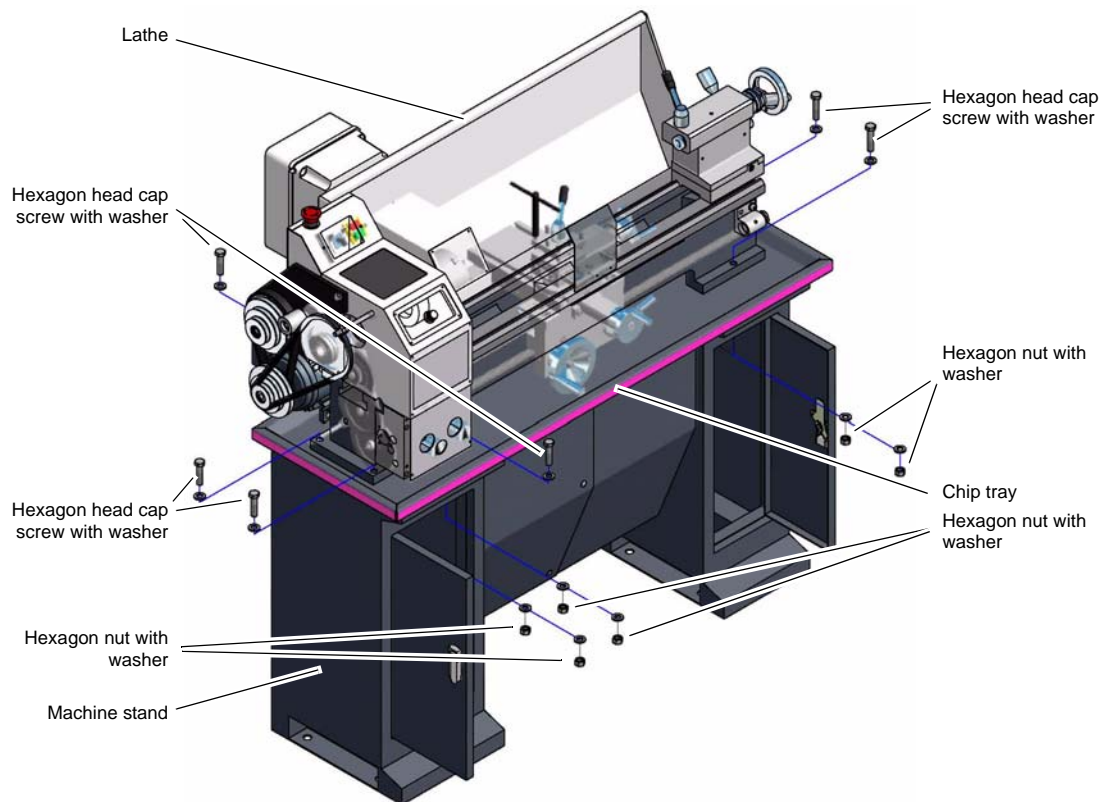

Fig.1-3: Assembly scheme of the lathe on the machine stand



WARNING!

Severe or lethal injuries due to damaged or insufficient bearing lifting gear and load suspension gear which might break under load.

- If required, align the machine stand. Make sure, that all holes of the lathe are superposing the holes of the collecting tray as well as of the machine stand.
- Fix the lathe on the machine stand using the attached fixing material. It is mounted from the inside of the side part.
- Firmly tighten all fixing screws.
- Check again, if all fixing screws are really firmly tightened.

1.3.3 Mounting the machine stand for D240x500 and D250x550

- Mount the front panels to the side parts of the machine stand as shown on Fig.1-1: „Assembly scheme machine stand - rear view“ on page 4 using the attached fixing material. Slightly tighten the hexagon socket screws.

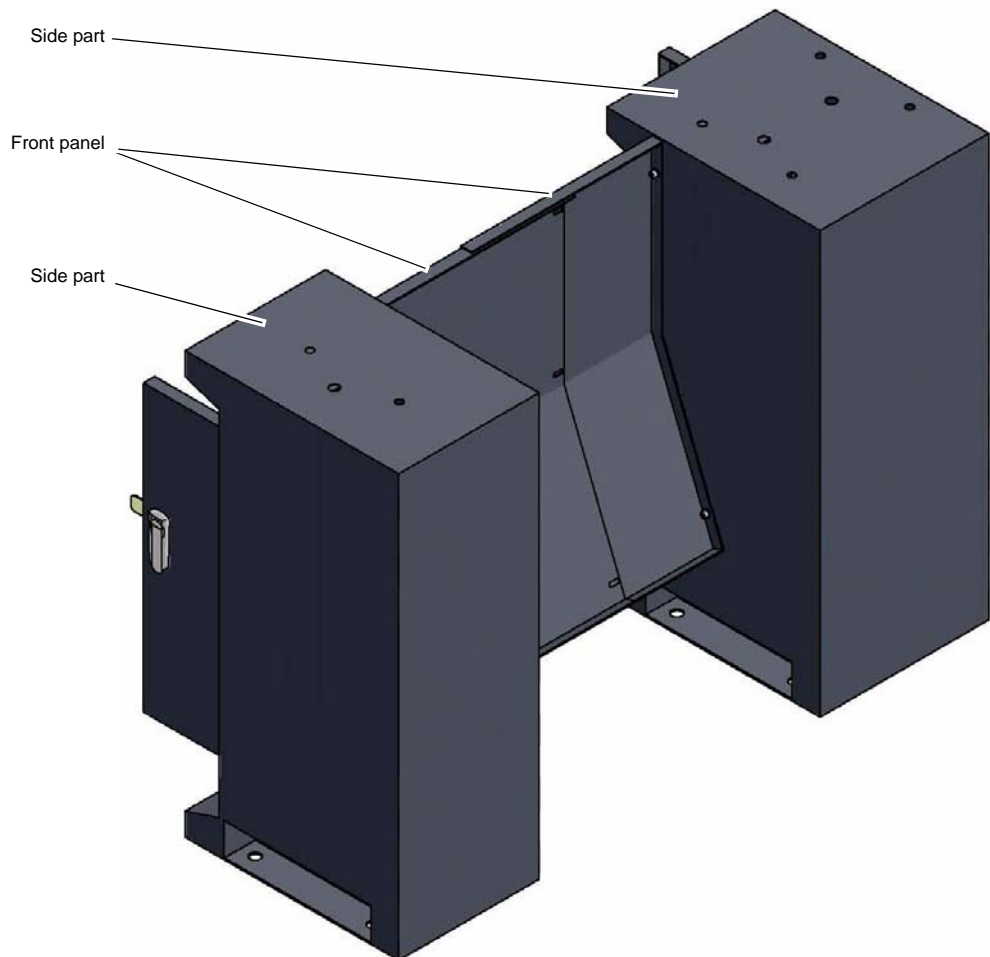

Fig.1-4: Assembly scheme machine stand - rear view

- Roughly align the two side parts with the mounted front panel.
- Put the collecting tray on the machine stand.
- Shift the two front panels into each other until the holes of the collecting tray and the holes of the side parts are superposed.
- Make sure that the front panel with the holes is lying at the top since the holes are used as guide for drilling.
- Clamp the two front panels before drilling in order to ease drilling through the front panels.
- Drill three holes of a diameter of 6.5 mm.

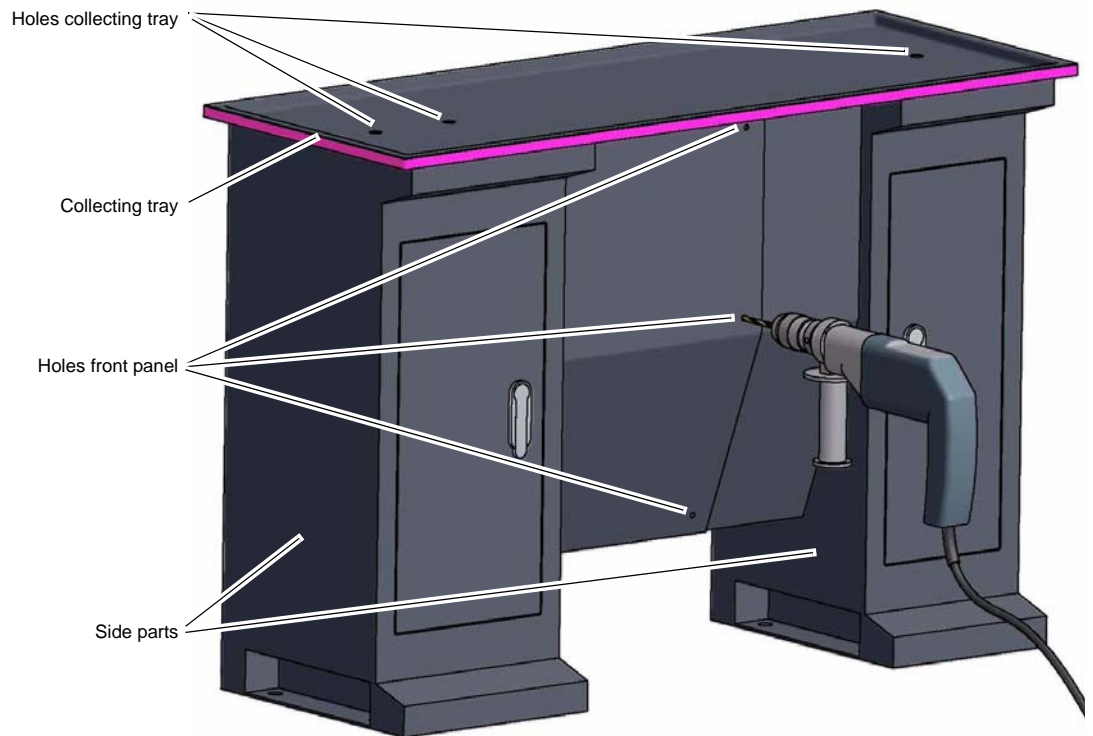

Fig.1-5: Mount and drill the machine stand

→ Screw the two front panels together using the button head screws and the hexagon nuts.

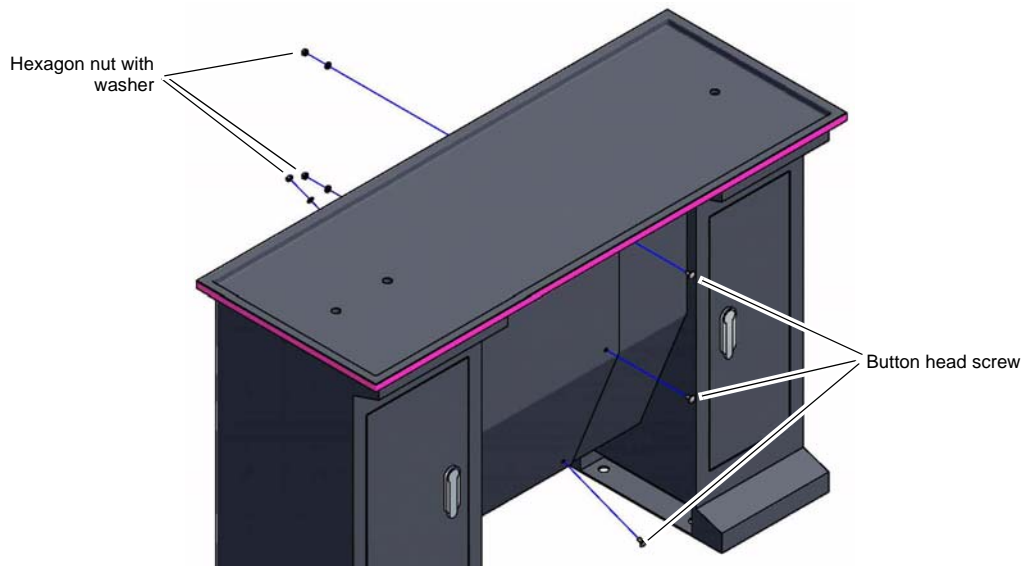

Fig.1-6: Mounting the machine stand

→ Lift the lathe on the machine stand using an appropriate handling device.



ATTENTION!

Make sure that the connecting cable is neither crushed nor damaged when lifting the lathe on the machine stand!

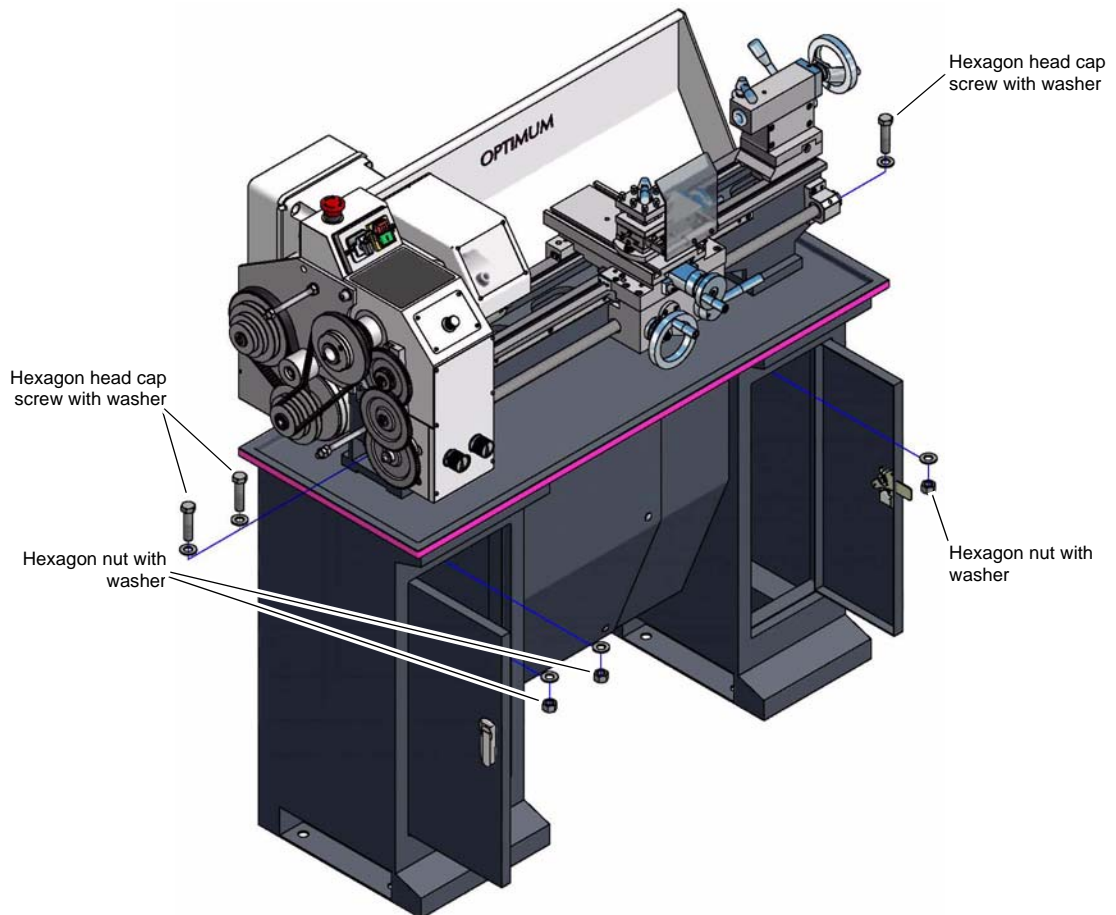

Fig. 1-7: Mounting the machine stand



WARNING!

Severe or lethal injuries due to damaged or insufficient stable lifting gear and load suspension gear which might break under load.

- If required, align the machine stand. Make sure, that all holes of the lathe are superposing the holes of the collecting tray as well as of the machine stand.
- Fix the lathe on the machine stand using the attached fixing material. It is mounted from the inside of the side part.
- Firmly tighten all fixing screws.
- Check again, if all fixing screws are really firmly tightened.

1.3.4 Mounting the machine stand for D210x400

- Roughly align the two side parts with the mounted front panel.
- Put the collecting tray on the machine stand.
- Shift the two front panels into each other until the holes of the collecting tray and the holes of the side parts are superposed.

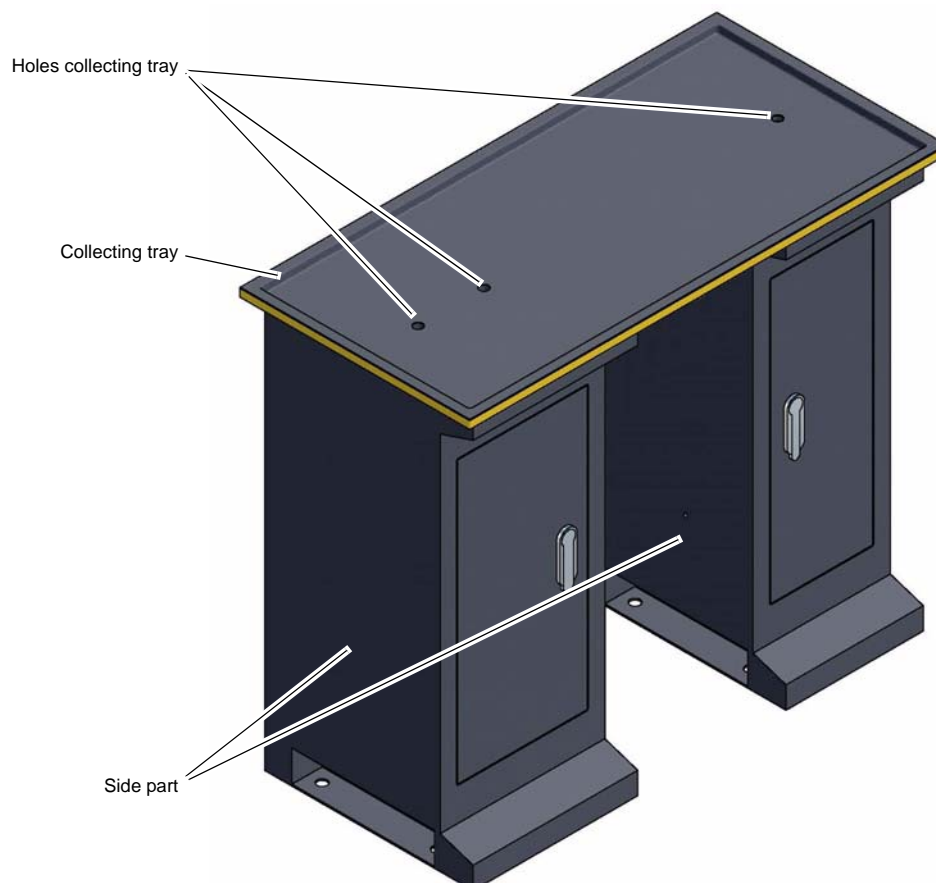

Fig.1-8: Installation of the machine stand for D210x400

- Lift the lathe on the machine stand using an appropriate handling device.



ATTENTION!

Make sure that the connecting cable is neither crushed nor damaged when lifting the lathe on the machine stand!



WARNING!

Severe or lethal injuries due to damaged or insufficient stable lifting gear and load suspension gear which might break under load.

- If required, align the machine stand. Make sure, that all holes of the lathe are superposing the holes of the collecting tray as well as of the machine stand.
- Fix the lathe on the machine stand using the attached fixing material. It is mounted from the inside of the side part.
- Firmly tighten all fixing screws.
- Check again, if all fixing screws are really firmly tightened.

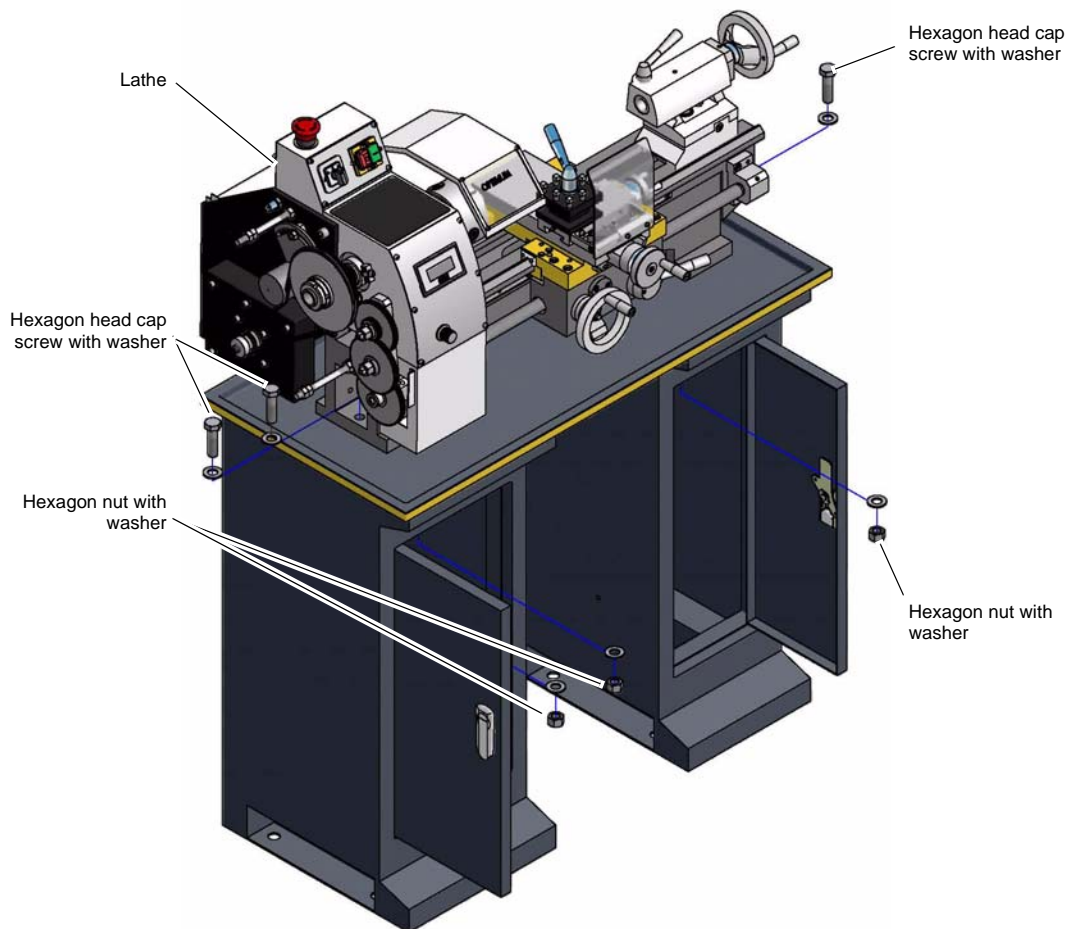

Fig. 1-9: Assembly of the lathe D210x400

1.3.5 Mounting the machine stand to the floor

→ Fix the machine stand to the subsoil of the machine, if it is electrically connected to the lathe stationary at the installation site.

We recommend you to use striker armatures or heavy-duty anchors!

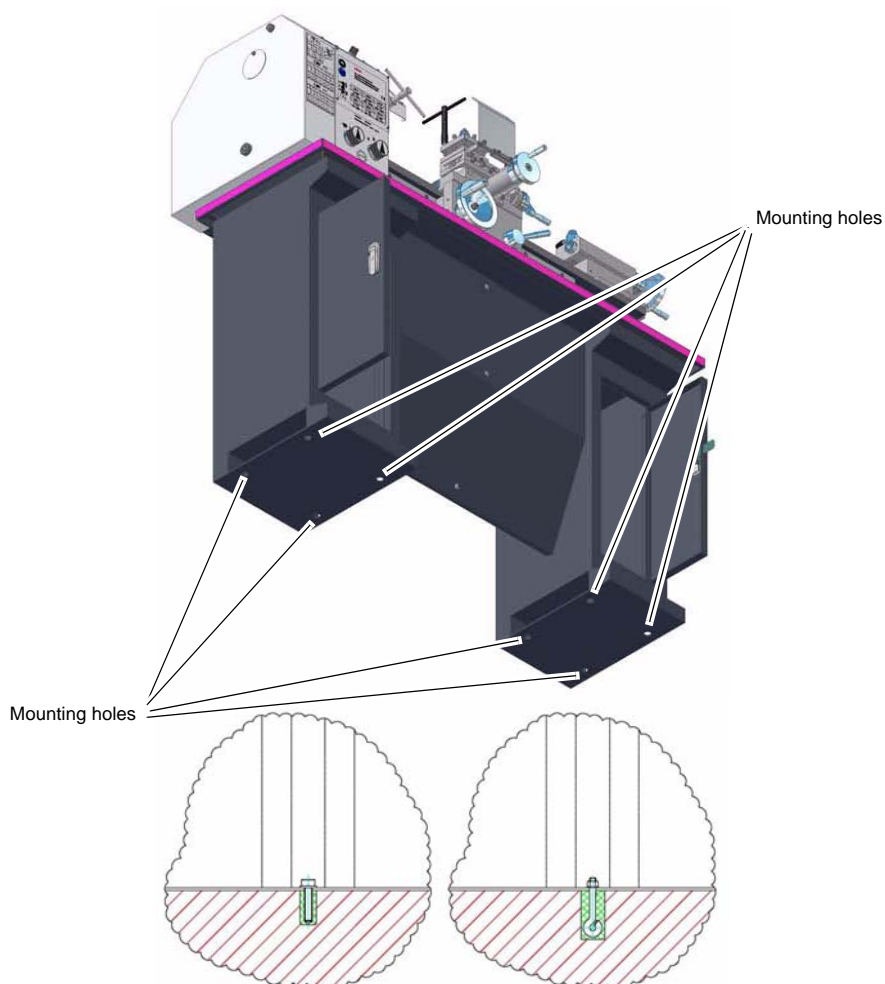

Fig.1-10: Example floor fixture for D280x700